



we are  
morfittsmith

560 Herries Road,  
Sheffield, S5 8TR





**A spacious mid terrace house with good sized front and back gardens. Herries Road is a fantastic location. With an abundance of local amenities and major road access. Perfect for the commuter!**







### **Why We Love It**

We love the garden space. A large front and rear garden, with lots of potential for socialising, hosting and even those with green thumbs! You can't beat a good garden in the summer, especially if this is a family home!



## Why you'll Love It

Herries Road is large in scale and brimming with potential. Downstairs comprising of a Kitchen, dining room and sizable Lounge. Featuring character fireplace and plenty of window space. Allowing for lots of natural daylight. Herries Road benefits from a front and rear garden, perfect for hosting on a warm summer's evening.

Upstairs you have the three bedrooms. Comprising of the large main bedroom with built in wardrobe. A family 3 piece bathroom with shower and bathtub. A great size home for a new family.

Herries Road boasts major road access and a great array of local amenities. With large supermarkets, such as Asda close by and Schools, helping out on that dreaded school run! Greenspace such as Cookson Park and Parkwood Spring are also a short trip away, for those who love the outdoors! Northern General Hospital, Sheffield City Centre and Kelham Island are also easy accessible and fast to get to. This really is a great location for everything you need at our fingertips!













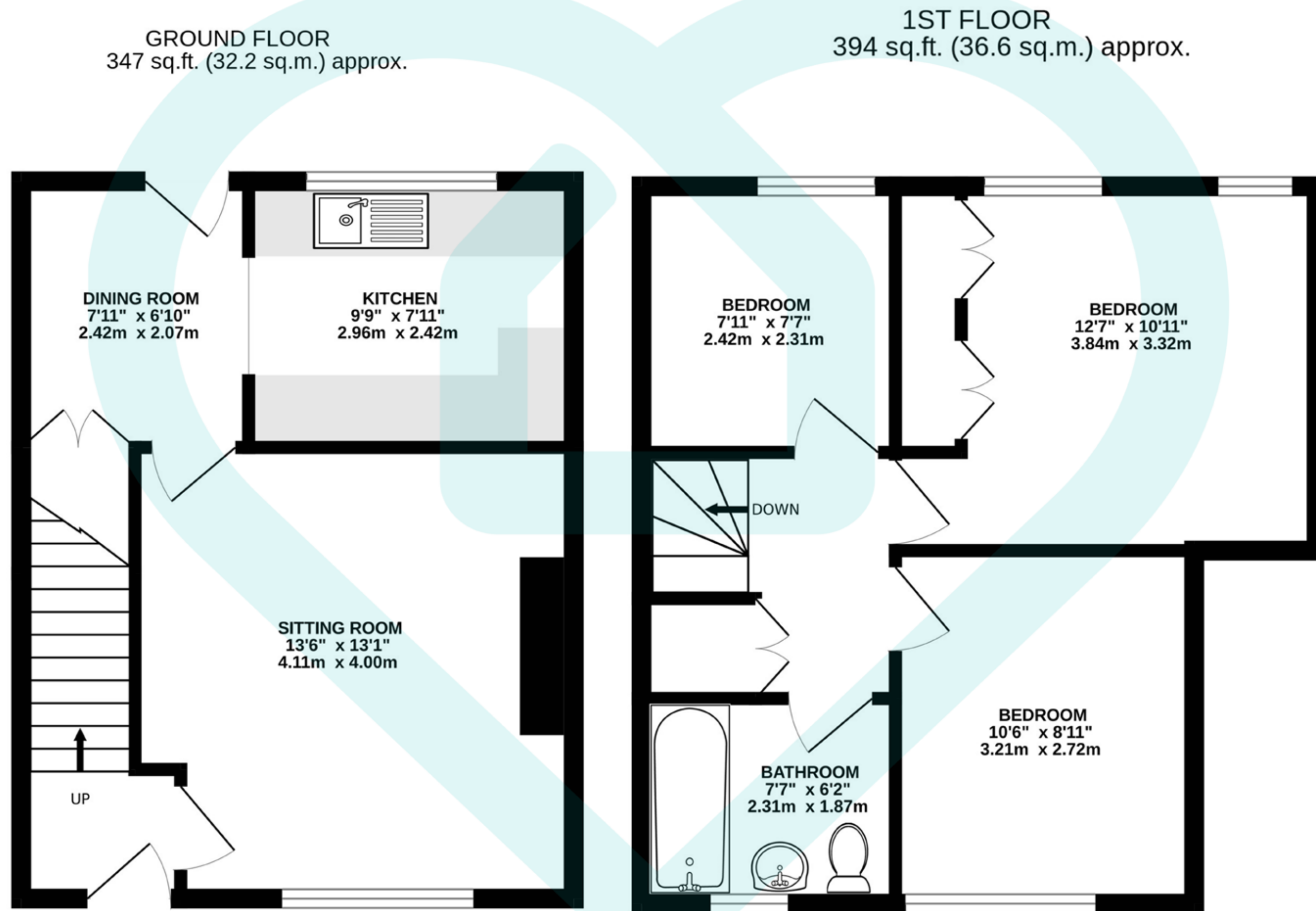

Score	Energy rating	Current	Potential
92+	<b>A</b>		
81-91	<b>B</b>		88   <b>B</b>
69-80	<b>C</b>	69   <b>C</b>	
55-68	<b>D</b>		
39-54	<b>E</b>		
21-38	<b>F</b>		
1-20	<b>G</b>		

This floor plan is for illustrative purposes only. All measurements and layouts are approximations and do not necessarily capture the precise specifications of the property. No responsibility is taken for any error, omission, or misstatement. We always recommend viewing in person to confirm the exact floor plan of a property. Made with Metropix.



IMPORTANT: we would like to inform prospective purchasers that these sales particulars have been prepared as a general guide only, A detailed survey has not been carried out, nor the services, appliances and fittings tested. Room sizes should not be relied upon for furnishing purposes and are approximate. If floor plans are included, they are for guidance only and illustration purposes only and may not be to scale. If there are any important matters likely to affect your decision to buy, please contact us before viewing the property.





The MorfittSmith Building,  
67 Middlewood Road,  
Sheffield, S6 4GX



0114 232 1764



[www.morfittsmith.co.uk](http://www.morfittsmith.co.uk)



[sales@morfittsmith.co.uk](mailto:sales@morfittsmith.co.uk)



[lettings@morfittsmith.co.uk](mailto:lettings@morfittsmith.co.uk)



[newhomes@morfittsmith.co.uk](mailto:newhomes@morfittsmith.co.uk)



@morfittsmith



@morfittsmith



MorfittSmith Estate & Letting Agent



# morfittsmith



## sales | lettings | new homes

---